

# AQUA MAX DATA SHEET

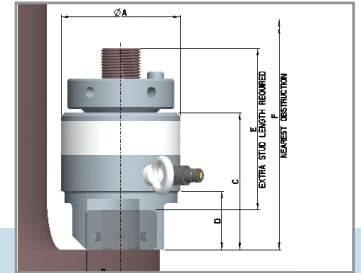
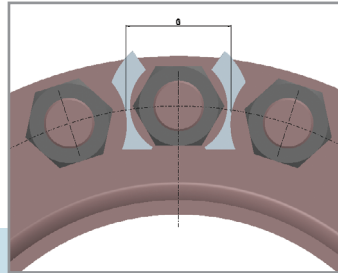

- Maximum Working Pressure 21,750 psi (1500 bar)
- All tools have 1.18in stroke except AM01 and AM02 = 0.79mm
- Weight excludes Reaction Nut
- Eccentric shaped tool applies to AM01, AM02 and AM03
- Tools forming the core range are AM03, AM05, AM07, AM09, AM11, AM13, AM15 & AM17
- Dimension 'G' is measured on tool centreline
- Product development is continually taking place and therefore certain dimensions could be subject to change
- \*Requires Reaction Nut Step-Up Washer

Tool Ref	Bolt Diameter		Tool HYD Area		Max Load			Weight		A	B	C	D	E	F	G
	in	mm	in <sup>2</sup>	mm <sup>2</sup>	Tonf	lbf	kN	lb	kg	in	in	in	in	in	in	in
AM01	3/4"	M20	1.39	894	13.45	30128	134.0	3.6	1.65	2.52	0.61	3.78	1.38	3.97	8.82	1.89
AM02	3/4"	M20	1.92	1241	18.67	41821	186.0	4.1	1.85	2.72	0.74	3.68	1.38	3.97	8.82	2.18
	7/8"	M22														
AM03	7/8" *	M20	2.52	1627	24.48	54835	244.0	6.6	3.00	3.19	0.78	4.82	1.81	5.04	11.61	2.34
	1"	M24														
		M27														
AM04	1"	M24	3.34	2154	32.42	72621	323.0	7.9	3.59	3.50	0.91	4.94	1.97	5.10	11.93	2.90
	1 1/8"	M27														
		M30														
AM05	1 1/8" *	M30	4.26	2748	41.36	92646	412.1	9.8	4.45	3.86	1.07	5.15	2.05	5.27	12.32	2.91
	1 1/4"	M33														
AM06	1 1/4"	M33	5.29	3414	51.38	115091	512.0	11.6	5.24	4.21	1.24	5.20	2.17	5.04	12.17	3.40
	1 3/8"	M36														
AM07	1 3/8" *	M36	6.44	4155	62.53	140067	623.0	14.4	6.52	4.55	1.31	5.43	2.30	5.40	12.83	3.40
	1 1/2"	M39														
AM08	1 1/2"	M39	7.70	4969	74.78	167507	745.1	17.8	8.05	4.92	1.34	5.69	2.42	5.66	13.35	3.78
	1 5/8"	M42														
AM09	1 5/8" *	M42	9.08	5855	88.12	197389	878.1	21.5	9.76	5.26	1.50	6.02	2.58	6.05	14.17	3.81
	1 3/4"	M45														
AM10	1 3/4"	M45	10.57	6817	102.59	229802	1022.2	24.2	10.99	5.61	1.69	6.06	2.66	5.87	14.17	4.27
	1 7/8"	M48														
	1 1/2"	M48														
AM11	1 7/8"	M48	12.17	7849	118.13	264611	1177.1	27.1	12.27	5.98	1.94	6.10	2.76	5.79	14.29	4.59
	2"	M52														
AM12	2" *	M52	15.70	10130	152.46	341510	1519.1	35.3	16.03	6.71	1.94	6.46	2.99	6.16	15.04	5.13
	2 1/4"	M56														
AM13	2 1/4"	M56	19.68	12696	191.08	428019	1904.0	42.5	19.27	7.30	2.32	6.61	3.23	6.05	15.35	5.65
	2 1/2"	M60														
		M64														
AM14	2 1/2" *	M60	21.82	14078	211.88	474611	2111.2	48.9	22.19	7.80	2.48	6.99	3.43	6.47	15.43	6.25
		M64														
	2 3/4"	M68														
		M72														
AM15	2 3/4"	M68	26.25	16934	254.85	570864	2539.4	61.4	27.86	8.44	2.70	7.40	3.74	6.80	17.24	6.93
	3"	M72														
		M76														
		M76														
AM16	3" *	M76	31.07	20048	301.72	675853	3006.3	75.2	34.12	9.17	2.73	7.68	4.06	7.22	18.11	7.33
	3 1/4"	M80														
		M85														
AM17	3 1/4"	M80	36.30	23421	352.48	789555	3512.1	87.2	39.55	9.76	3.08	7.87	4.29	7.09	18.39	7.82
	3 1/2"	M85														
		M90														
AM18	3 1/2"	M90	41.95	27062	407.29	912330	4058.2	116.3	52.77	10.63	3.17	8.76	4.51	8.54	20.47	8.56
	3 3/4"	M95														
AM19	3 3/4"	M95	47.99	30964	466.02	1043885	4643.4	139.7	63.37	11.34	3.53	9.22	4.76	8.78	21.42	9.13
	4"	M100														

Further details can be obtained from your local Hydratight representative or via the website [www.hydratight.com](http://www.hydratight.com)

**hydratight**