

## MorSafe™ Online Bolt Renewal Clamp (ASME 8 Bolt Flange)

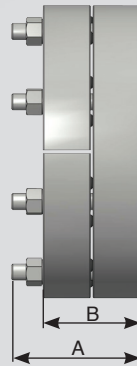
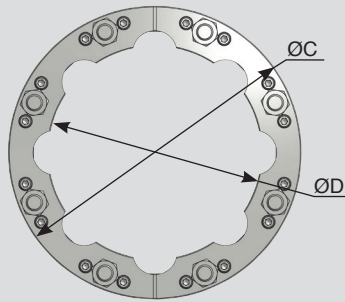
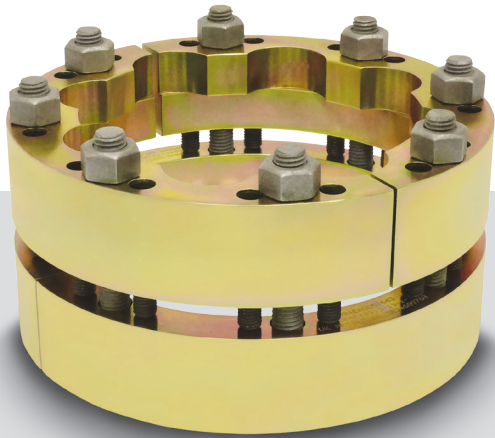

Hydratight offers Bolt Renewal Services on all ASME flanges, allowing services to be performed without any damage, leakage or interruptions in daily production.

Our service covers:

- All ASME flanges, all sizes, all pressure ratings
- All services, subjected to a risk assessment
- Piping system temperature between -30°C (-22°F) to 150°C (300°F)

Our service teams use a robust, yet simple hot bolting clamp. It does not require any pneumatics or hydraulics for clamp engagement, so it requires less bulky systems for a given flange size. The lightweight and compact design fits almost all flange space restrictions; it is easy to handle and fit, therefore enabling speedy bolt replacement.

The clamp consists of segments that are bolted around the flange, with patented backstops which prevent the clamp pre-tensioning from being transferred directly to the flange. Clamps for 8-bolted flanges have an enclosed design with space for use of a hydraulic socket wrench, spanner and twist socket.

### 8 Bolt Specifications

Assembly Number	Pipe size (inch)	Flange Class	Bolt Dia.	Overall Thickness w studs (A)		Overall Thickness w/o studs (B)		O.D. (C)		I.D. (D)		Overall Weight	
				mm	in	mm	in	mm	in	mm	in	kg	lbs
N0400A0150AB	4	150	5/8"	150	5.91	92.6	3.65	280	11.02	203.5	8.01	16.7	36.7
N0500A0150AB	5	150	3/4"	150	5.91	94.6	3.72	305	12.01	228.5	9.00	18.2	40.0
N0600A0150AB	6	150	3/4"	150	5.91	99.8	3.93	341	13.43	249	9.80	26.1	57.3
N0800A0150AB	8	150	3/4"	150	5.91	108.0	4.25	408	16.06	314	12.36	35.5	78.0
N0200A0300AB	2	300	5/8"	120	4.72	93.4	3.68	207	8.15	144	5.67	9.4	20.6
N0300A0300AB	3	300	3/4"	150	5.91	108.0	4.25	261	10.28	184.5	7.26	16.9	37.3
N0400A0300AB	4	300	3/4"	150	5.91	116.4	4.58	305	12.01	228.5	9.00	22.8	50.2
N0200A0600AB	2	600	5/8"	150	5.91	104.8	4.13	216	8.50	139.5	5.49	13.4	29.4
N0208A0600AB	2.5	600	3/4"	150	5.91	115.2	4.54	242	9.53	161	6.34	16.3	35.8
N0300A0600AB	3	600	3/4"	170	6.69	125.6	4.94	272	10.71	180	7.09	24.4	53.8
N0400A0600AB	4	600	7/8"	180	7.09	138.2	5.44	344	13.54	244	9.61	39.7	87.2
N0500A0600AB	5	600	7/8"	200	7.87	155.0	6.10	400	15.75	300	11.81	52.4	115.3
N0300A0900AB	3	900	7/8"	190	7.48	138.2	5.44	303	11.93	211	8.31	30.0	65.9
N0400A0900AB	4	900	1-1/8"	220	8.66	159.0	6.26	370	14.57	262	10.31	52.2	114.8
N0200A1500AB	2	1500	7/8"	190	7.48	138.2	5.44	278	10.94	186	7.32	26.9	59.1
N0300A1500AB	3	1500	1-1/8"	220	8.66	163.4	6.43	345	13.58	237	9.33	49.4	108.8
N0400A1500AB	4	1500	1-1/4"	240	9.45	178.0	7.01	397	15.63	281	11.06	70.4	154.9
N0200A2500AB	2	2500	1"	220	8.66	167.8	6.61	305	12.01	205	8.07	40.6	89.3
N0300A2500AB	3	2500	1-1/4"	260	10.24	209.4	8.24	391	15.39	275	10.83	80.6	177.3
N0400A2500AB	4	2500	1-1/2"	300	11.81	234.4	9.23	459	18.07	326	12.83	127.4	280.3
N0600A2500AB	6	2500	2"	400	15.75	308.0	12.13	623	24.53	454	17.87	304.5	669.9

Further details can be obtained from your local Hydratight representative or via the website [hydratight.com](http://hydratight.com).